

LEGEND

-  Dropped kerb (driveaway)
-  Non public highway
-  Proposed double yellow line
-  Single yellow line
-  Existing double yellow line
-  Permit bay (proposed)
-  Disabled bay
-  Permit and paid bay (proposed)
-  Existing school keep clear markings
-  Project area boundary

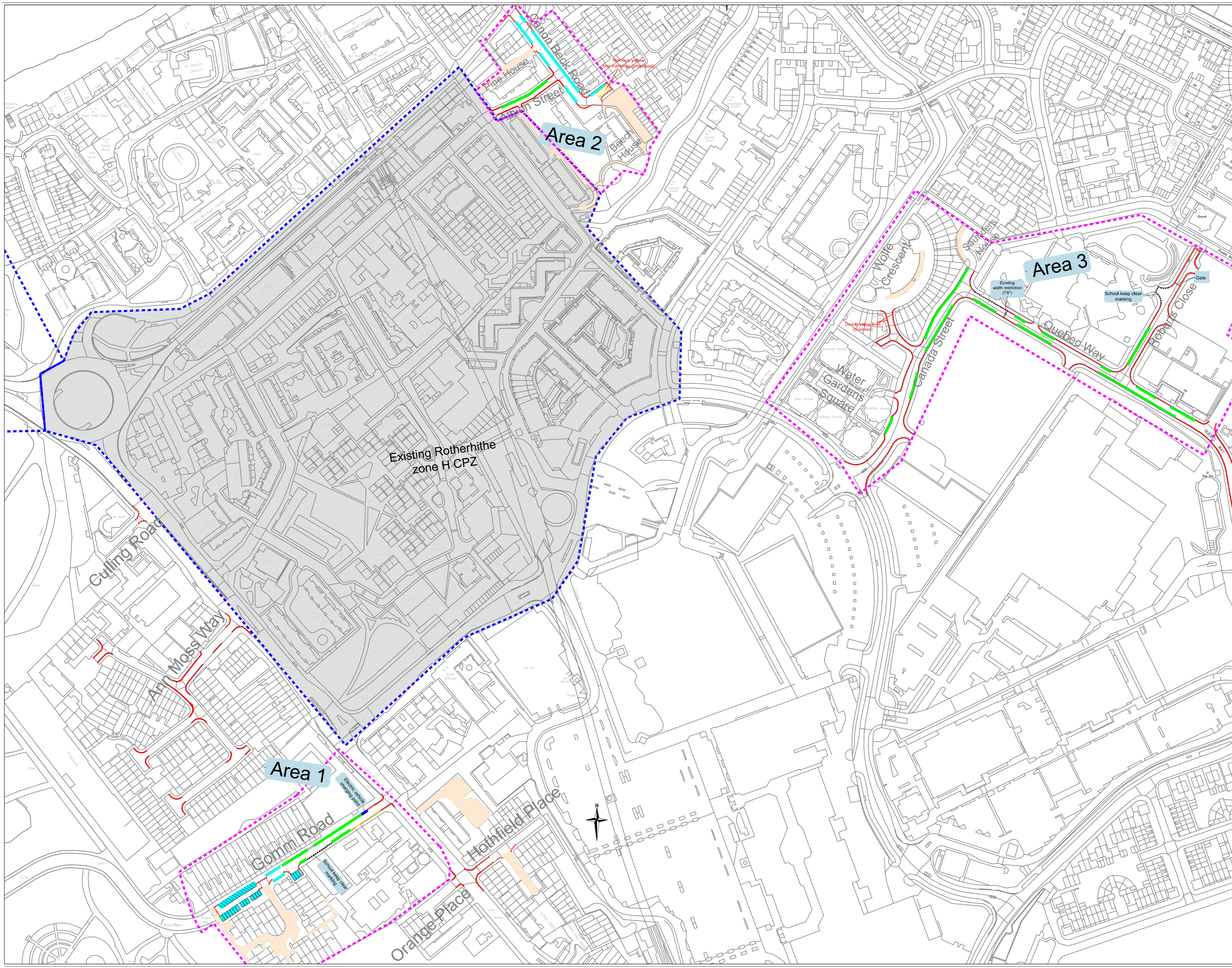

Revision details	By	Date	Suffix
Initial drawings	DA	01/07/15	A
Final drawings	DA	21/06/15	B

Project ID / name  
CANADA\_WATER

Drawing title  
CANADA\_WATER  
PROPOSED\_CONTROLLED\_PARKING\_ZONE

Layout  
DETAILED\_DESIGN

Scale  
1:1000

File Name  
DA

Drawn	Designed	Checked	Approved
DA	DA	TW	TW
01/07/15	01/07/15	01/07/15	01/07/15

This map is based on Ordnance Survey material with the permission of Ordnance Survey on behalf of the Controller of Her Majesty's Stationery Office © Crown copyright. Unauthorised reproduction infringes Crown copyright and may lead to prosecution or civil proceedings. (01/10/01232) 2011